



LINEBRACE™

LineBrace vertical pipe support is a clamping system that supports the weight of A/C vertical piping and reduces the thermal expansion load on the lowest elbow by 50%.

To find out more, visit www.InabaDenko-America.com

TKL PIPE SUPPORT (NON-BRAZE)

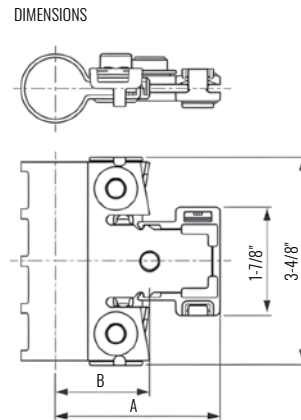

MODELS	COMPATIBLE PIPE SIZES	A	B
TKL-3K	3/8"	2-3/8"	1-1/4"
TKL-4K	1/2"	2-1/2"	1-3/8"
TKL-5K	5/8"	2-1/2"	1-3/8"
TKL-6K	3/4"	2-5/8"	1-1/2"
TKL-7K	7/8"	2-5/8"	1-1/2"
TKL-8K	1"	2-3/4"	1-5/8"
TKL-9K	1-1/8"	2-7/8"	1-5/8"
TKL-10K	1-1/4"	2-7/8"	1-3/4"
TKL-11K	1-3/8"	2-7/8"	1-3/4"
TKL-12K	1-1/2"	3"	1-7/8"
TKL-13K	1-5/8"	3-1/8"	2"
TKL-14K	1-3/4"	3-1/8"	2"

SPECIFICATIONS

- Reduces weighted load on vertical riser
- Reduces thermal expansion load by 50%
- Can be used in retrofit projects
- Compatible with most pipe sizes
- Exclusive insulation technology

MATERIAL

- **Main body:**
Fixation band: SUS304
Nut fixation plates: PP
Hex nuts M8 (3 pieces): SUS
- **Hex bolts:**
M8 x 23L (SUS 3 pieces)

Vertical lineset installations are always subject to severe stress due to a combination of thermal expansion and gravity, usually resulting in buckling and deformation of the fittings at the lower end of each pipe run.

▶ **LineBrace solves these problems and simplifies installation.**

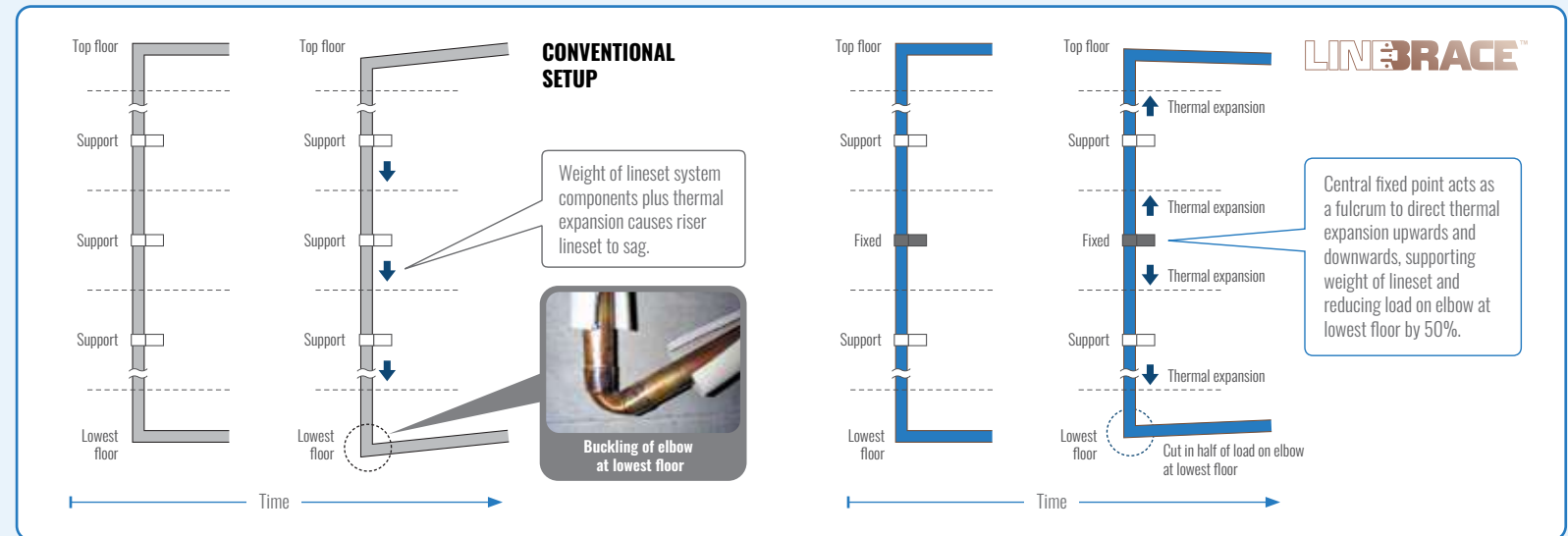

COMPLETED SETUP



BASE

Material: Highly corrosion-resistant hot-dip galvanized steel sheets (Cation electrodeposition coating + acrylic paint).



INSULATION

Material: Polyethylene foam with factor of 30.

LOAD CAPACITY

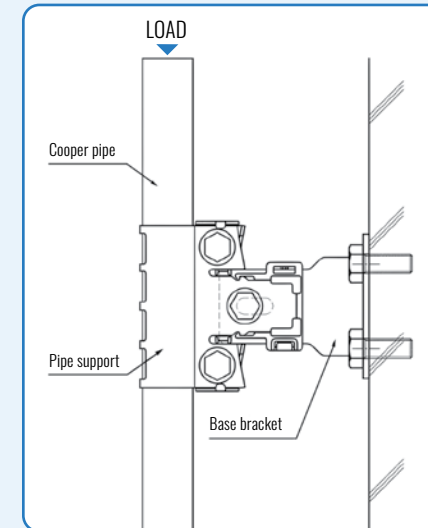

MODELS	KG	N	LBS
TKL-3K	279	1245	615
TKL-4K	293	1304	645
TKL-5K	319	1421	700
TKL-6K	339	1510	745
TKL-7K	368	1642	810
TKL-8K	405	1804	890
TKL-9K	449	2002	985
TKL-10K	493	2201	1085
TKL-11K	542	2414	1190
TKL-12K	595	2650	1310
TKL-13K	652	2907	1435
TKL-14K	714	3179	1570

- The load capacity indicates the load that the test piece is capable of supporting the copper pipe when load is given to that test piece.